

24	256.0 [10.078]	352.0 [13.858]	445.2 [17.527]	553.7 [21.799]	604.5 [23.799]	419.1 [16.500]	606.6 [23.881]	431.5 [16.988]
22	256.0 [10.078]	/	419.8 [16.527]	502.9 [19.799]	553.7 [21.799]	419.1 [16.500]	555.8 [21.881]	406.0 [15.984]
20	256.0 [10.078]	/	394.4 [15.527]	452.1 [17.799]	502.9 [19.799]	215.9 [8.500]	505.0 [19.881]	381.0 [15.000]
18	256.0 [10.078]	/	343.6 [13.527]	401.3 [15.799]	452.1 [17.799]	215.9 [8.500]	454.2 [17.881]	330.5 [13.011]
16	/	/	313.9 [12.358]	/	401.3 [15.799]	215.9 [8.500]	403.4 [15.881]	300.0 [11.811]
14	/	/	263.1 [10.358]	/	350.5 [13.799]	215.9 [8.500]	352.6 [13.881]	249.5 [9.822]
12	/	/	212.3 [8.358]	/	299.7 [11.799]	215.9 [8.500]	301.8 [11.881]	199.0 [7.834]
SIZE (IN)	A	B	C	D	E	F	SLIDE LENGTH	TRAVEL

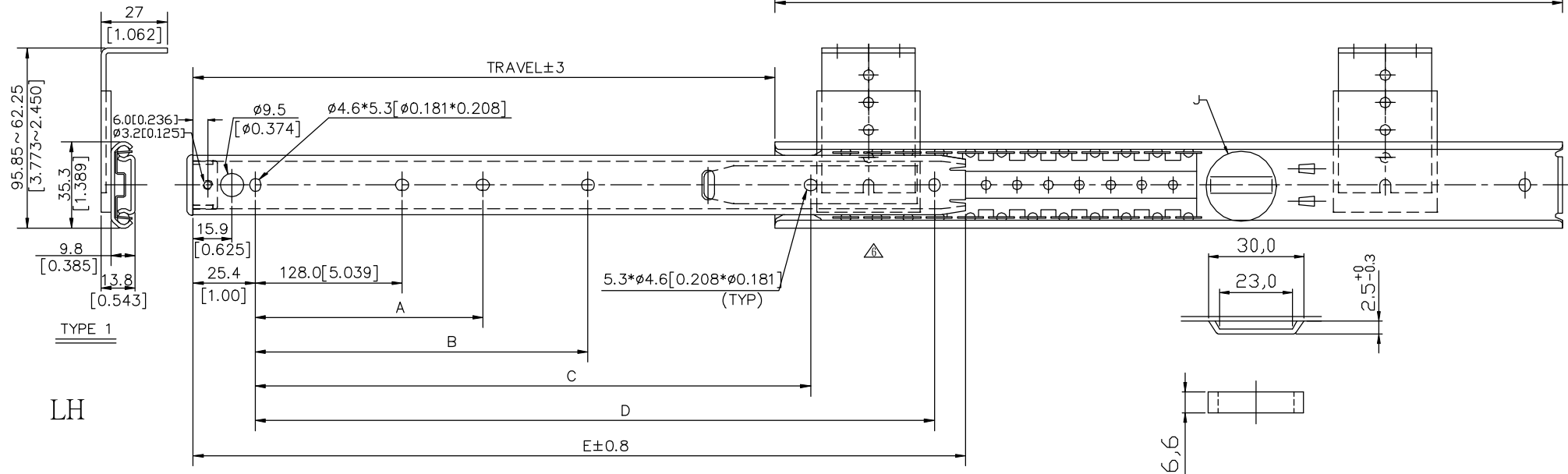
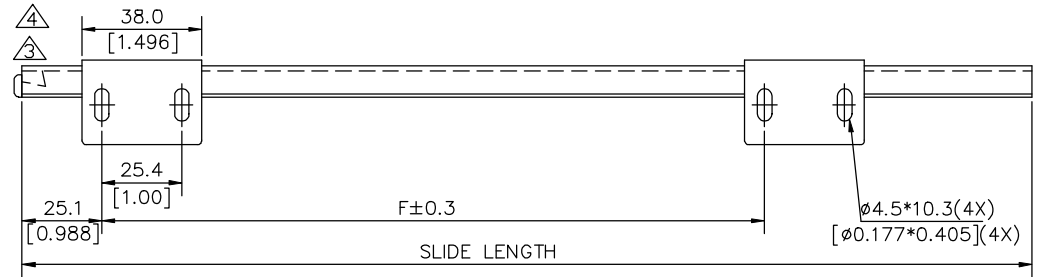
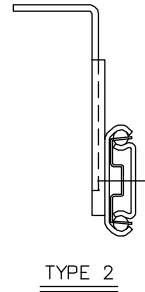

- NOTES:
- Material Spec: Slide member - cold rolled steel, retainer - galvanized steel, bearing - carbonized steel, Lubricant - anti-wear, high-low temperature grease
 - Loading: 50# (22 kgf) based on 18"
 - Functional Spec: 5 degree C to 35 degree C (room temperature)
 - Finish: zinc plated
 - (P1)/Detent force : 0 kgf/piece
 - (P2)/pull force : 0.3-1.0kgf/piece
 - Slide must be measured at the area where ball bearings fully support for slide thickness
 - Slide is provided with disconnect

TOLERANCES ARE FOLLOWS UNLESS OTHERWISE SPECIFIED		REV	DATE	DESCRIPTION	DRW
.XX[.XXX]	±0.30[±0.012]	3			
.X[.XX]	±0.76[±0.03]				
HOLE	±0.15[±0.006]				
ANGLE	±1°				
SCALE					
UNIT	mm[in]				
CLASSIFICATION					

DRW:	CUSTOMER P/N:
DATE: 1994/12/22	CUSTOMER
CKD:	APPD:

TSS3513 RAW	
TITLE:	MODEL:
MATERIAL:	P/N:
FINISH:	SHEET 1 OF 1

